

HARBOUR PLAZA NORTH POINT
Reservations hotline
Tel: (852) 2185 2888
Fax: (852) 2185 2000
Email: rsvn.hpnp@harbour-plaza.com

GLOBAL DISTRIBUTION SYSTEMS
Sabre UI 51542
Apollo/Galileo UI 54984
Amadeus UI HKGHPN
Worldspan UI 80250

HARBOUR PLAZA HOTELS & RESORTS
HONG KONG
▪ Harbour Grand Hong Kong
▪ Harbour Grand Kowloon
▪ Harbour Plaza Metropolis
▪ Harbour Plaza North Point
▪ Harbour Plaza Resort City
▪ Harbour Plaza 8 Degrees
▪ Kowloon Harbourfront Hotel
▪ The Kowloon Hotel
▪ Rambler Garden Hotel
▪ Rambler Oasis Hotel

OTHER RESERVATION NUMBERS:
AUSTRALIA
▪ Sydney : (61) 414011391
CHINA
▪ Beijing : (86 10) 6539 1396
▪ Guangzhou : (86 20) 3815 9278
▪ Shanghai : (86 21) 5404 1051
GERMANY
▪ Düsseldorf : (49 211) 405 6504
INDIA
▪ Bangalore : (91 80) 4149 7160
▪ Haryana : (91 124) 4986002
▪ Mumbai : (91 22) 6604 0300
JAPAN
▪ Tokyo : (81 3) 5413 5780
KOREA
▪ Seoul : (82 2) 554 9459
RUSSIA
▪ Moscow : (7 495) 621 4445
SINGAPORE
▪ Singapore : (65) 6332 1826
TAIWAN
▪ Taipei : (886 2) 2507 5721
UK
▪ Leisure : (44) 1638 507122
USA
▪ California : (1 707) 677 9067
▪ New York : (1 212) 253 9606

BAR & RESTAURANTS



Hoi Yat Heen Chinese Restaurant (3/F)

An award-winning Chinese restaurant offers delectable dim sum and Chinese cuisines from Canton, Shanghai, Sichuan and Yunnan. It's innovative "Dim Sum and Dessert Combo" had been honoured Silver Award in the Dim Sum Category in "Best of the Best Culinary Awards" by the Hong Kong Tourism Board.



Greens Café (2/F)

An All-day dining restaurant provides bountiful buffets and an extensive international menu in a relaxing atmosphere.



The Point Lobby Lounge (2/F)

Located on hotel lobby floor, offers all kinds of fine wines and exquisite snacks with live entertainment, an ideal venue for happy hour or a sports broadcast rendezvous.



Java Mama Deli Corner (1/F)

Amazing choices of custom-made sandwiches, fresh salads and nutritious light meals.



FLOOR PLAN

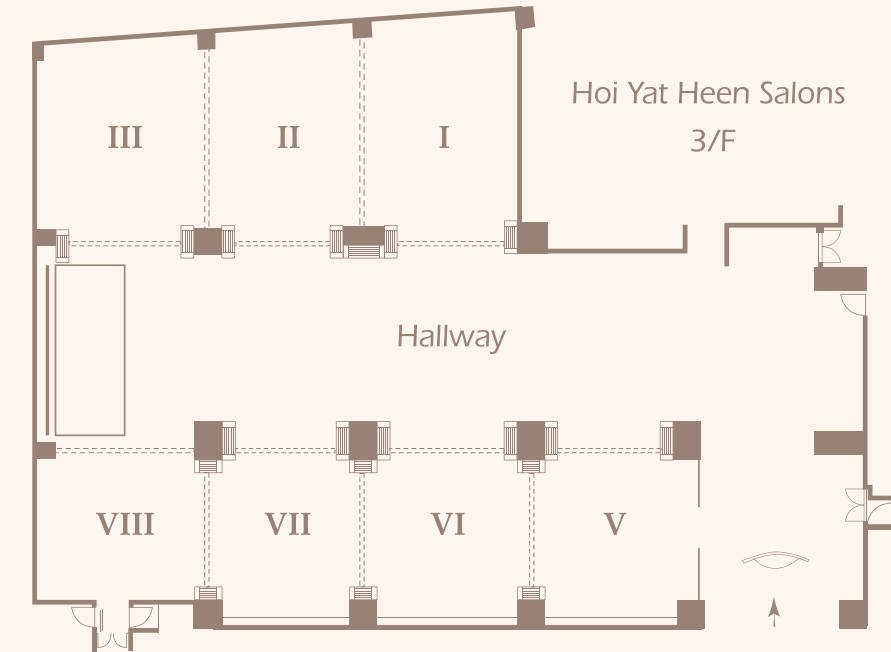

CAPACITY CHART

Venue	Sq. ft.	Sq. m.	Length		Width		Height	
			Feet	Metre	Feet	Metre	Feet	Metre
Hoi Yat Heen Salons	7,505	696	95	29	79	24	13	4
Java I	485	45	22	6.7	22	6.7	10	3
Java II & III	1,040	96	52	16	20	6	10	3
Harbour Plaza Rooms	1,160	108	61	18.6	19	5.8	9	2.7

Venue	Classroom	Theatre	Boardroom	U-shape	Buffet	Cocktail	Round Table
Hoi Yat Heen Salons	192	556	190#	180Δ	300	500	456
Java I	18	50	20	18	24	40	36
Java II & III	54	96	50	44	60	80	72
Harbour Plaza Rooms	60	130	50	44	72	110	72

Combination of 3 square boardroom tables Δ Combination of 3 U-shaped tables

MEETING AND BANQUET FACILITIES

Versatile function rooms are available on Basement One, Greens Café (2/F) and Hoi Yat Heen Salons (3/F) that are ideal to cater 15 – 550 persons' business meetings or social functions.



Convenient Location

Harbour Plaza North Point is located in between the bustling Causeway Bay and commercial hub Quarry Bay. It is just one-minute walking distance to MTR Quarry Bay Station (Exit C) and five-minute distance by hotel complimentary scheduled shuttle bus to the renowned shopping centre "Cityplaza" with over 160 international branded shops and restaurants and office complex of Taikoo Place.



GUEST SERVICES AND FACILITIES

- 25-meter outdoor swimming pool (closed in winter)
- Well-equipped fitness centre with sauna, solarium and massage service
- Non-smoking floors
- Complimentary hotel shuttle bus service to Taikoo Place office complex and Cityplaza Shopping Centre
- Complimentary scheduled shuttle bus service to Hong Kong Convention & Exhibition Centre on selected trade fairs
- Limousine service
- Valet Parking service
- Private dining service
- Business Centre
- 24-hour professional security & surveillance cameras
- 24-hour hotel concierge and front desk service
- Valet laundry and dry cleaning service
- Baby-sitting service
- Postal service and mail delivery
- Currency exchange



MONTHLY SERVICED SUITES

Monthly Serviced Suites are categorized into Studio, One - Bedroom Suite and Two - Bedroom Suite. They are well equipped with open kitchen or kitchen. The full hotel service with flexible leasing terms, no utility and maintenance cost are definitely your ideal "HOME AWAY FROM HOME".

In addition to the above features, Serviced Suites also come with:

- Housekeeping maid service (twice a week)
- Towel & linen service (twice a week)
- Refrigerator & microwave oven
- Double hot-plate & exhaust ventilation system
- Basic cooking utensils, Chinawares and cutleries
- Direct phone number (upon request)
- Free local calls
- Individually controlled air-conditioning
- Broadband or Wi-Fi Internet connection
- Access to self-service coin-laundry room



PREMIER ROOMS

Tastefully appointed, **Premier Rooms** are the epitome of urban dwelling with elegance, offering spectacular harbour views or a bright, ample hillside view. The clean and sleek rooms combine comfort living with classy and refined decor featuring designer chairs and an artistic feature wall, giving guests' stay a stylish yet homey touch.

Premier Plus Rooms are situated on the hotel's top floors, also boasting panoramic views of the iconic Victoria Harbour, or a wide, airy view of the lush greeneries. Guests can relax and enjoy a warm and heart-soothing stay with a series of exclusive privileges.

Premier Plus Room Exclusive Privileges :

- Welcome fruit plate
- Daily local newspaper
- Complimentary buffet breakfast at Greens Café
- Complimentary drinks during Happy Hours at The Point Lobby Lounge
- Complimentary consumption of mini bar items
- Complimentary use of meeting room for 2 hours (subject to availability) and advanced reservation is required
- Complimentary pressing service for 1 suit (2 pieces) per stay
- Free local calls
- 20% discount at Greens Café and Hoi Yat Heen Chinese Restaurant
- 20% discount on services in Business Centre
- 20% discount on massage, facial and solarium service
- 10% discount on laundry and pressing service (except dry cleaning and express service)

Both Premier Room and Premier Plus Room are equipped with a chic chaise longue for guests to sit back and relax, while it can also be transformed into a bed to accommodate an extra accompanying guest for a delightful and cosy stay.



Two-Bedroom Suite

900 sq.ft (84 sq.m)

One Bedroom Suite

580 sq.ft (54 sq.m)

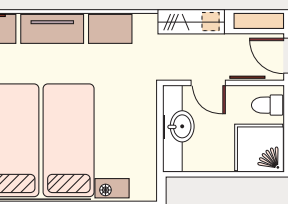
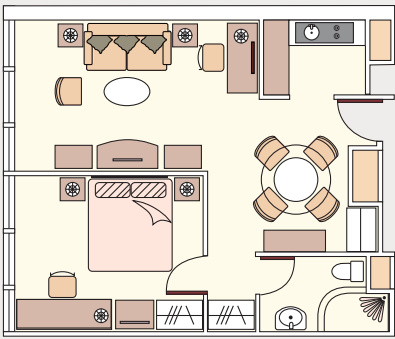

Superior Room/ Deluxe Room

290 sq.ft (27 sq.m)

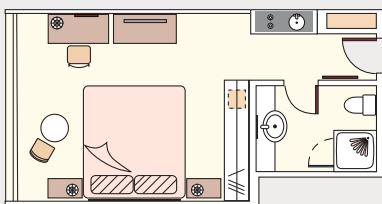

Studio

290 sq.ft (27 sq.m)

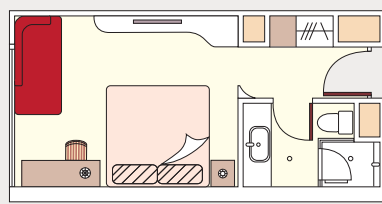

Premier Room

290 sq.ft (27 sq.m)

TRANSPORTATION

From	Time	By
Mass Transit Railway (MTR) Quarry Bay Station "Exit C"	1 min	Walk
Cityflyer A12 (Model Housing Estate, King's Road)	1 min	Walk
Bus Station (Model Housing Estate, King's Road)	1 min	Walk
Tram Station (Java Road)	1 min	Walk
Taikoo Place office complex	3 min	Walk / Shuttle Bus
Cityplaza Shopping Centre	5 min	Shuttle Bus
North Point Ferry Terminal	10 min	Walk
Causeway Bay Shopping District	10 min	MTR / Taxi
Hong Kong Convention & Exhibition Centre	12 min	MTR / Taxi / Shuttle Bus*
Central	15 min	MTR / Taxi
Airport Express Hong Kong Station	15 min	MTR / Taxi / H4#
Ocean Park / Repulse Bay / Stanley Market	20 min	Taxi
Kwun Tong & Tseung Kwan O	20 min	MTR / Taxi
Hong Kong International Airport	45 min	Airport Express / Taxi / Cityflyer A12
Hong Kong Disneyland	45 min	MTR / Taxi
AsiaWorld-Expo	47 min	Airport Express

*Available on selected trade fairs only #By Airport Express

Remarks: All information is subject to change without prior notice

Remarks: All information is subject to change without prior notice